

Technical Service Bulletin

ExoAir Air Barrier Products – Exterior Sheathing Detailing

This bulletin is in regards to the detailing of exterior sheathing boards prior to applying the ExoAir sheet products: ExoAir 110, ExoAir 110LT, and ExoAir TWF; and the ExoAir fluids: ExoAir 120, ExoAir 220, and ExoAir 230 air barrier membranes. It is extremely important that detailing be done properly in order to ensure proper and continuous application of the air barrier membranes. The following are detailing recommendations:

- **Board installation:** It is important that exterior sheathing boards are properly fastened and secure. Contact the exterior sheathing manufacture for complete installation instructions. Loose or improperly fastened boards should be properly repaired and fastened prior to installation of ExoAir membranes. Broken, damaged boards, or areas where the paper facing has torn should be replaced with new boards and properly fastened prior to membrane installation.
- **Fastener detail:** The screw heads of the fasteners securing the exterior sheathing are not required to be detailed prior to installing ExoAir sheet products. However, it is highly recommended to detail the screw heads with Tremflex 834 when installing ExoAir fluids. The ExoAir fluids are not 100% solids and will form around the screw heads during the cure period (see the photo below). Although this area could be continuous and have the proper mil thickness, the appearance of the screw heads becomes areas of concern when the walls are inspected. In order to properly ensure complete and consistent coverage it is a best practice recommendation to detail over the screw heads with Tremflex 834 (Detail A10289).

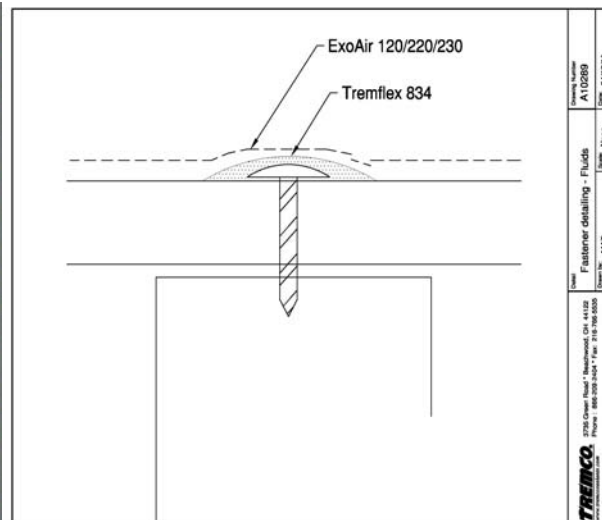

- Board joint detailing:** The gaps of the board joints need to be properly detailed in order to ensure continuity of the membrane. The board joints can be detailed with Tremflex 834 for gaps from 1/16"-1/4" when installing the ExoAir fluids (Detail A10508) or for ExoAir sheet products 1/4"-1/2" (Detail A10509). When detailing with sealant mesh tape is not required. However, when applying ExoAir 230, the other option for detailing board joints is to apply ExoAir 230 and Tremco 2011 mesh tape (Detail A10802).

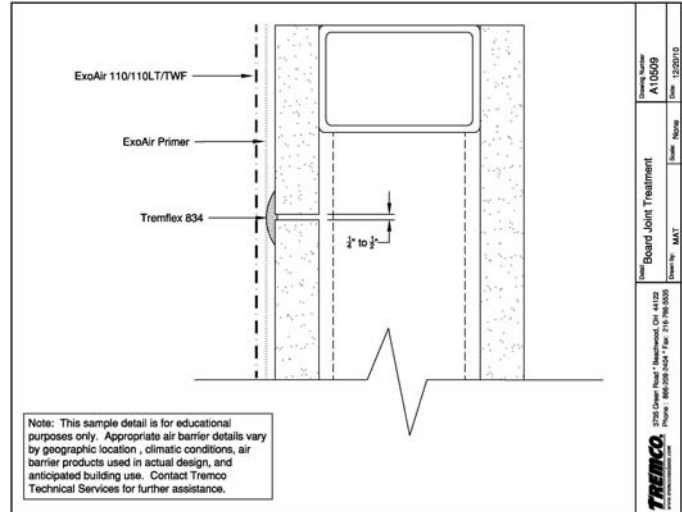
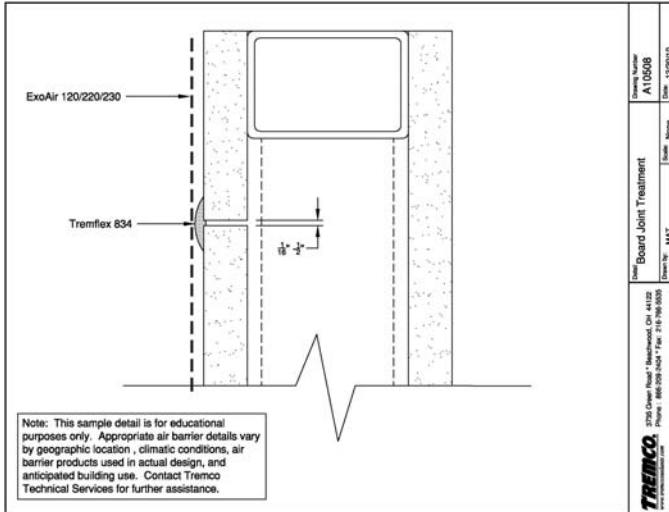

- Priming:** Depending on the type of exterior sheathing being used, multiple coats of ExoAir Primer may be required. ExoAir Primer is required to be used when installing all ExoAir Sheet products: ExoAir 110/110LT and ExoAir TWF. ExoAir Primer should be roller applied resulting in full coverage of the exterior sheathing. The ExoAir Primer is green in color and should be continuous over the entire surface that will be receiving the ExoAir sheet. This includes existing cured ExoAir membranes, sealant, and any other additional substrates. The ExoAir Primer should be allowed to dry to a tacky non-transferable surface prior to installing the ExoAir Sheet. The ExoAir sheet should then be mechanically rolled with a seam roller in order to ensure long term adhesion and performance.

Please contact Tremco Technical Service at 866-209-2404 with any questions regarding this bulletin.